



# SE572

## Installation, Maintenance and Operating Instructions

### DESCRIPTION

Deck mounted EMERGENCY AERATED EYE WASH unit. Eye wash is supplied with a 15mm stay open full flow ball valve, activated by an activation paddle handle. Unit swivels 90 degrees for easy access to sink when not required. Mounts to countertops up to 40mm thick. Manufactured by PBA Safety to comply with AS 4775 - 2007

### EYE/FACE WASH

Eye/Face Wash: Aerated Eyewash  
Valve: 15mm Stainless Steel  
Activator: 304 Stainless Steel Push Handle

### FLOW DATA

Eye/Face Wash  
Flow Pressure: 138 KPa  
Flow Rate: 12 LPM

### INSTALLATION

After unpacking carton, ensure all components are present. At desired location. Drill a 25mm diameter hole through countertop (40mm thick max). Be sure hole is drilled as straight as possible. Attach eyewash to countertop using supplied hardware. Fit activation handle and fasten. Once the unit is securely mounted connect water supply to 15mm male connection. Failure to use potable water can result in emergency units producing impure or contaminated water causing possible further injury. Test unit.

### TESTING

The Australian Standards AS4775-2007 states that all safety equipment shall be activated on a weekly basis to flush the line and verify proper operation. All units include a testing tag to be filled out weekly.

**NOTE:** This unit should be connected to an uninterrupted source of potable water, no less than 15mm with a minimum flowing pressure of 138KPa and a maximum static pressure of 860 KPa.

### OPERATION

The eye wash is activated by pushing the paddle handle back 90 degrees. The unit will operate until the paddle handle is manually pulled to the off position.

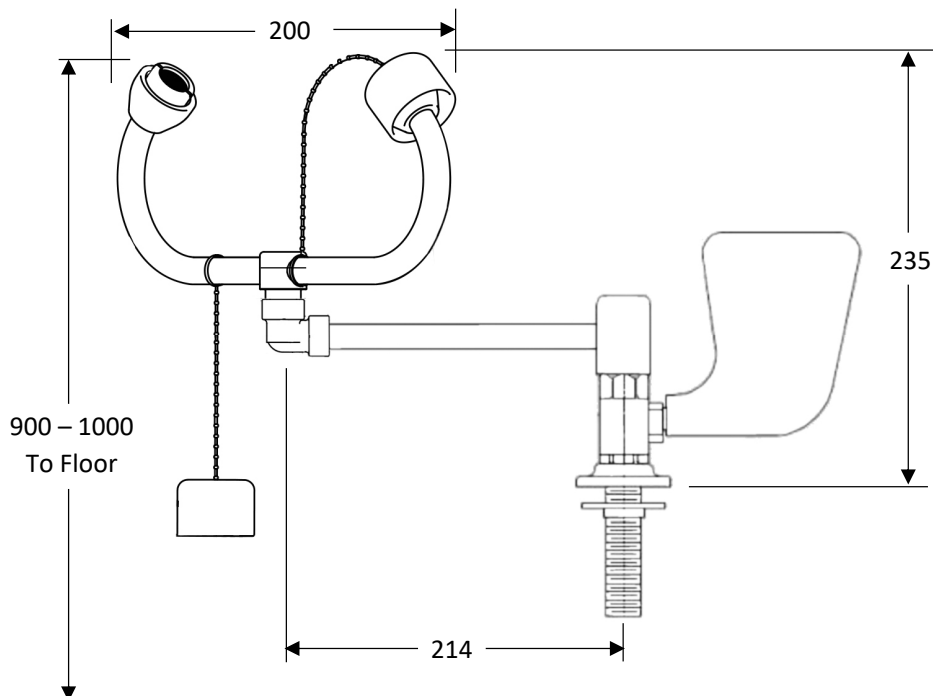
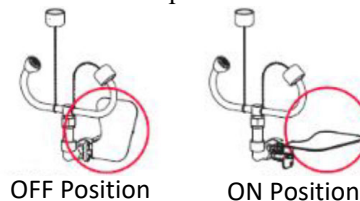

**WARNING:** Use only genuine Speakman parts when replacing or repairing components.

To order free call 1800 444 022 or free fax 1800 444 024

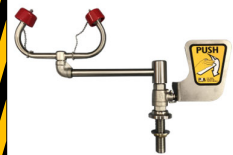

SE572  
Bench Mounted Swivel  
Aerated Eye Wash

# Installation, Maintenance and Operating Instructions

## MAINTENANCE

Should you need to repair this unit, please see the parts list for correct part numbers. Before any maintenance is done **be sure the water supply is shut off.**

## MAINTENANCE SCHEDULE

Activate eyewash unit and allow water

**Weekly** to flow for 30 seconds to flush line.

Ensure water flows evenly from both outlets.

Ensure water is clean.

**Yearly** Ensure unit complies with AS 4775 – 2007.

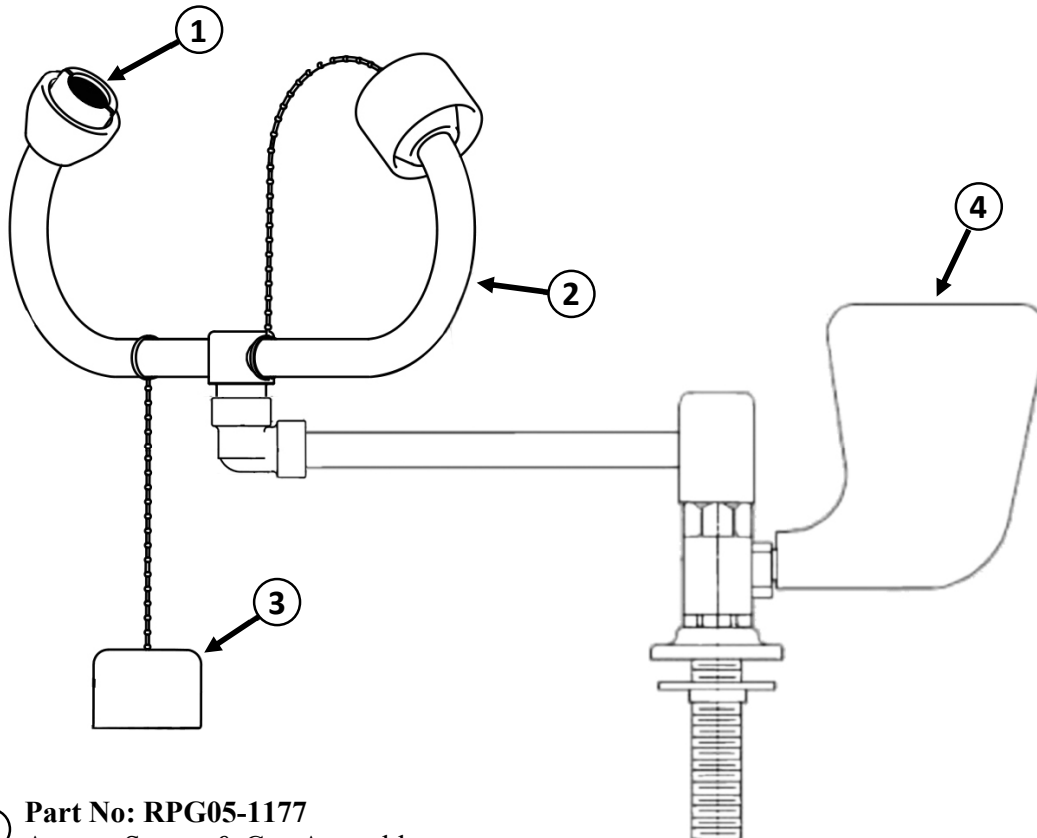

- ① **Part No: RPG05-1177**  
Aerator Screen & Cap Assembly



- ② **Part No: SA 01003-572**  
Complete Bulls Horns Assembly

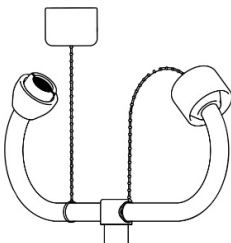

## SPARE PARTS LIST

| No: | Description:                   | Part No:     |
|-----|--------------------------------|--------------|
| 1.  | Aerator, Screen & Cap Assembly | RPG05-1177   |
| 2.  | Complete Bull Horns Assembly   | SA 01003-572 |
| 3.  | Dust Cap Assembly              | SA 01008     |
| 4.  | 15mm Ball Valve & Push Handle  | SE 910V      |

**WARNING:** Use only genuine Speakman parts when replacing or repairing components.

To order free call 1800 444 022 or free fax 1800 444 024

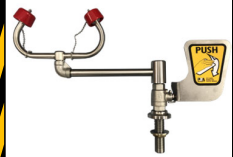

**SE572**  
**Bench Mounted Swivel**  
**Aerated Eye Wash**

**PBA**  
**SAFETY**  
1800 444 022  
WWW.PBASAFETY.COM.AU